

## Part. S0112

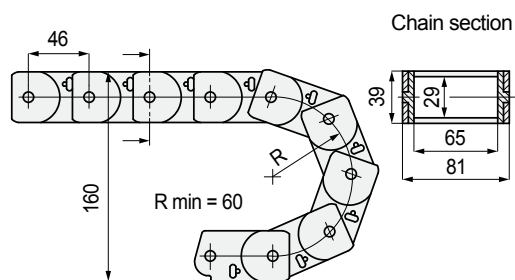

### ■ Cable carriage chain



#### Code

51610

- Use: for carrying cables and hoses in the machine and protecting them from tensile and torsional stress.
- Material: polyamide PA (black).
- Assembly of engaged links: the engagement system allows a quick easy dismantling.
- Packaging: 5 metres.

### • Calculation of chain length L

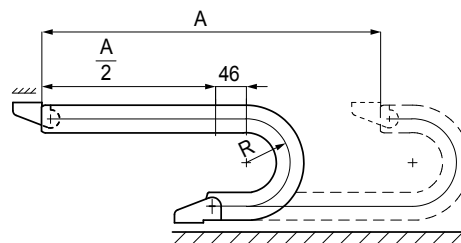

$$L = \frac{A}{2} \cdot \pi + R \cdot \pi + (46 \cdot 2)$$

L = chain length (mm).  
A = chain stroke (mm).  
R = curving radius (mm).

## Part. S0114



### ■ Attachments

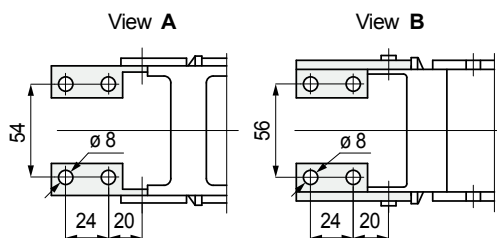

#### Code

59040

- Material: zinc plated steel.
- State of supply: complete with No. 4 connections.
- Packaging: 5 kit.

### • Assembly of Part. S0114

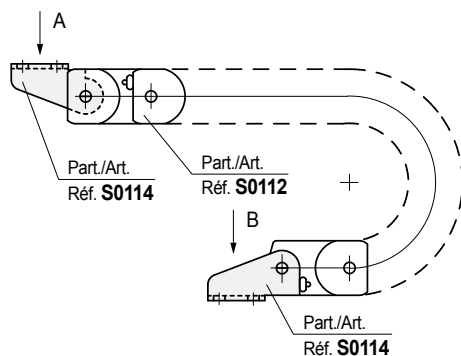

● Best Seller

● Standard

● On request: minimum quantity may apply.  
Consult our Customer Service for availability.

Item code for order = Part. + Code